

Cylindrical Knob Conversion Kit for 901 Handpiece

Remove existing knob from the 901 handpiece by loosening retainer ring counter-clockwise (ILL. A). Unscrew the body counter-clockwise out of the knob (ILL. B). Place body into Cylindrical Knob and turn clockwise until snug. Tighten retainer ring against knob (ILL. C). Make sure O-ring is between the knob and the retainer ring.

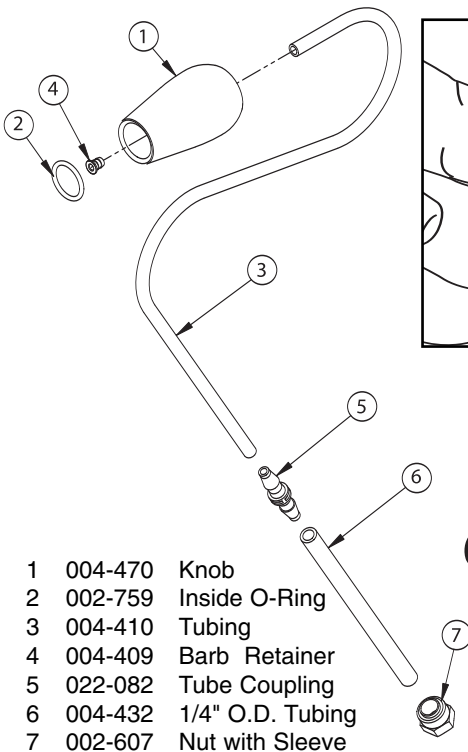
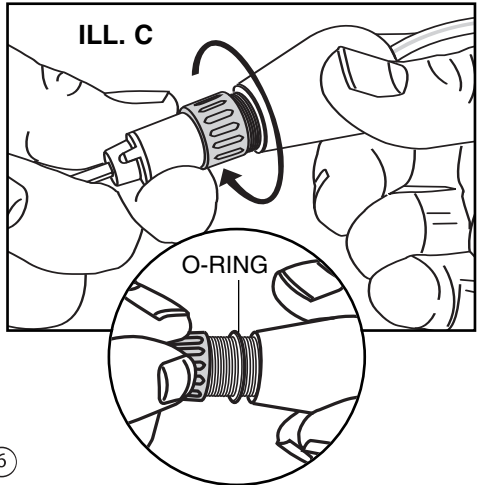
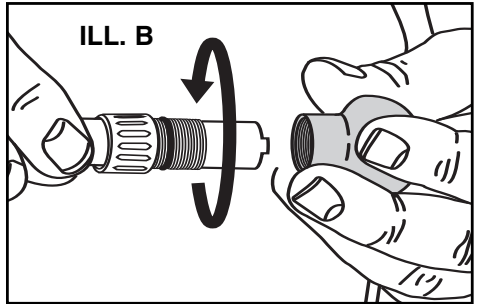
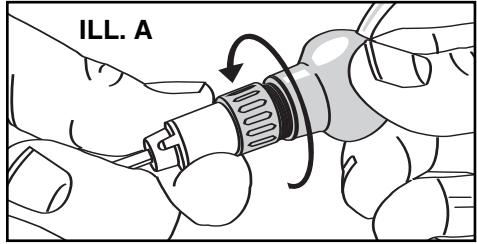

900 Overlander Road
Emporia, KS 66801

Toll Free: 800-835-3519
Phone: 620-343-1084
Fax: 620-343-9640
e-mail: GRS@GrsTools.com