

# GRS Airtact Palm Touch Element PARTS LIST

for Monarch Handpiece • PART #004-952 & PART #004-952SS

Part No.	Description	Part No.	Description
002-590	O-Ring, 7/16" x 9/16" x .070"	044-110-C2	Palm Pad C2
002-607	Nut, with sleeve	044-110-D1	Palm Pad D1
004-416	Locking nut	044-130	Airtact control line 050-054 x 48" length
004-416SS	Stainless steel locking nut for #004-952SS	044-131	3/4" length of heat shrink
004-422	Hose/barb retainer	004-948	Monarch Palm Element Knob
004-423	Handpiece tubing, 3/32" ID x 38" long	004-948SS	Stainless steel Monarch Palm Element Knob for #004-952SS
004-431	1/4" OD x .17" I.D. x 10" urethane tubing		
022-082	Tube coupling, 5/32"		
023-024	SFHMS, #2-56 x 3/16"		
023-029	Male 3/32" ID tube		

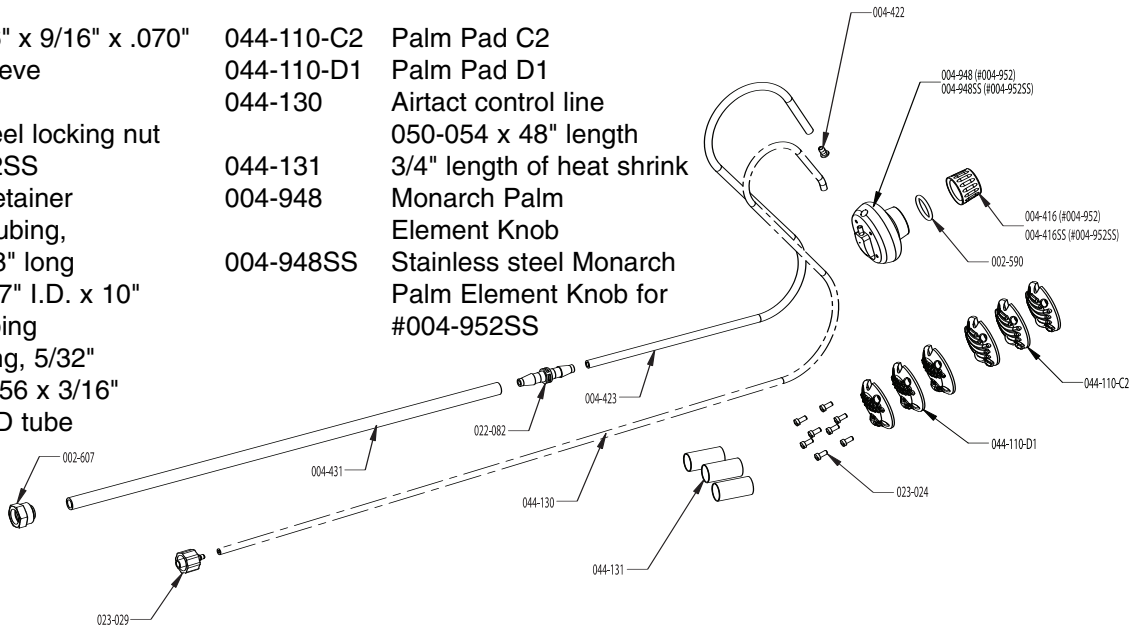

You must install a Palm Pad before using the handpiece. We recommend that you start with 044-110-C2. For details on Palm Pad use, please read the instructions included with your Airtact or visit [www.airtact.com](http://www.airtact.com). **NOTE:** The four (4) screws (#023-024) that hold the Touch Element to the knob must be tightened gently. DO NOT over tighten as damage will result.

# GRS Airtact Palm Touch Element PARTS LIST

for 901 Handpiece • PART #004-953 & PART #004-953SS

Part No.	Description
002-607	Nut, with sleeve
002-759	O-ring, 1/2" x 5/8" x 1/16"
004-403SS	Stainless steel locking nut for #004-953SS
004-409	Hose/barb retainer
004-410	40" length of 050-005
004-432	1/4" OD x .17" I.D. x 4" urethane tubing
022-082	Tube coupling, 5/32"
023-024	SFHMS, #2-56 x 3/16"
023-029	Male 3/32" ID tube
044-110-C2	Palm Pad C2
044-110-D1	Palm Pad D1
044-129	Locking nut
044-130	Airtact control line 050-054 x 48" length
044-131	3/4" length of heat shrink
004-949	901 Palm Element knob
044-949SS	Stainless Steel 901 Palm Element knob for #004-953SS

You must install a Palm Pad before using the handpiece. We recommend that you start with 044-110-C2. For details on Palm Pad use, please read the instructions included with your Airtact or visit [www.airtact.com](http://www.airtact.com). **NOTE:** The four (4) screws (#023-024) that hold the Touch Element to the knob must be tightened gently. DO NOT over tighten as damage will result.

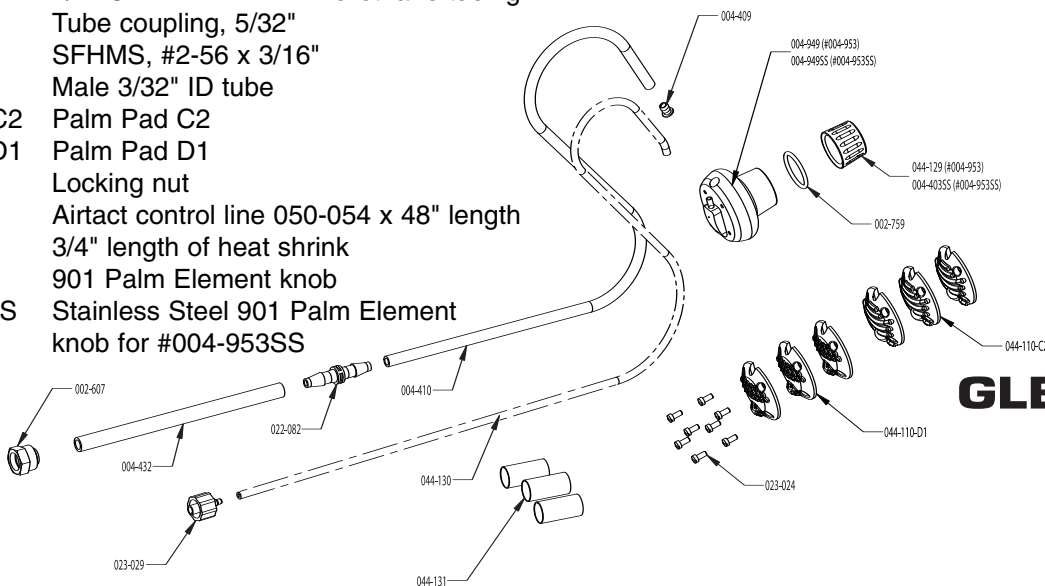

**GLENDO**  
CORPORATION

900 Overlander Road  
P.O. Box 1153  
Emporia, KS 66801 USA  
800-835-3519 • 620-343-1084  
fax 620-343-9640  
[glendo@glendo.com](mailto:glendo@glendo.com)  
[www.grstools.com](http://www.grstools.com)

LIT-299